

A B C D E F G H K L M N

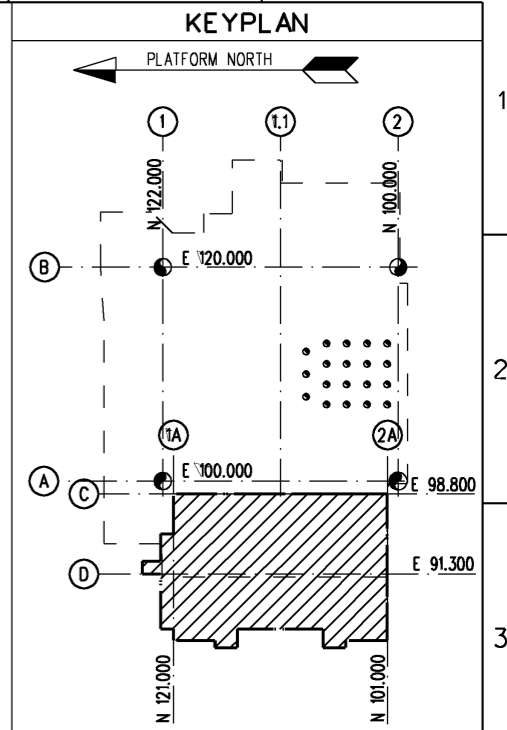

- NOTES:**
- LEGEND :
- CABLES WIRED TO WI-711/WI-708A/B
  - CABLES WIRED TO WI-709
  - INSTRUMENT REQUIRING A CABLE
  - INSTRUMENT REQUIRING AN AIR SUPPLY LINE.
  - INSTRUMENT REQUIRING AN HYDRAULIC SUPPLY LINE.

- REFERENCE DRAWINGS
- P&ID W-PI-030
  - W-PI-032
  - W-PI-033
  - W-PI-035
  - W-PI-036
  - W-PI-037
  - W-PI-038
  - W-PI-040
  - PIPING C.A 00.07.00.PA 14
  - 00.07.00.PA 15
  - 00.07.00.PA 16

**ABB** ABB OFFSHORE TECHNOLOGY AS  
HEEREMA TONSBERG

**VALHALL EQM PROJECT**

CLIENT  
**AMOCO** AMOCO NORWAY OIL COMPANY

|                 |  |                                  |         |                 |          |
|-----------------|--|----------------------------------|---------|-----------------|----------|
| DRAWN BY        |  | SIGNED                           |         | DATE            |          |
| CHECKED BY      |  | TITLE                            |         | 8               |          |
| APPROVED BY     |  | INSTRUMENT LAYOUT EQUIPMENT DECK |         | EL. +30.300     |          |
| APPROVED CLIENT |  | SCALE                            | JOB No. | DRAWING No.     | SHT. No. |
|                 |  | 1:50                             |         | 00-67-10-11-002 | 1        |
|                 |  |                                  |         |                 | REV Z1   |

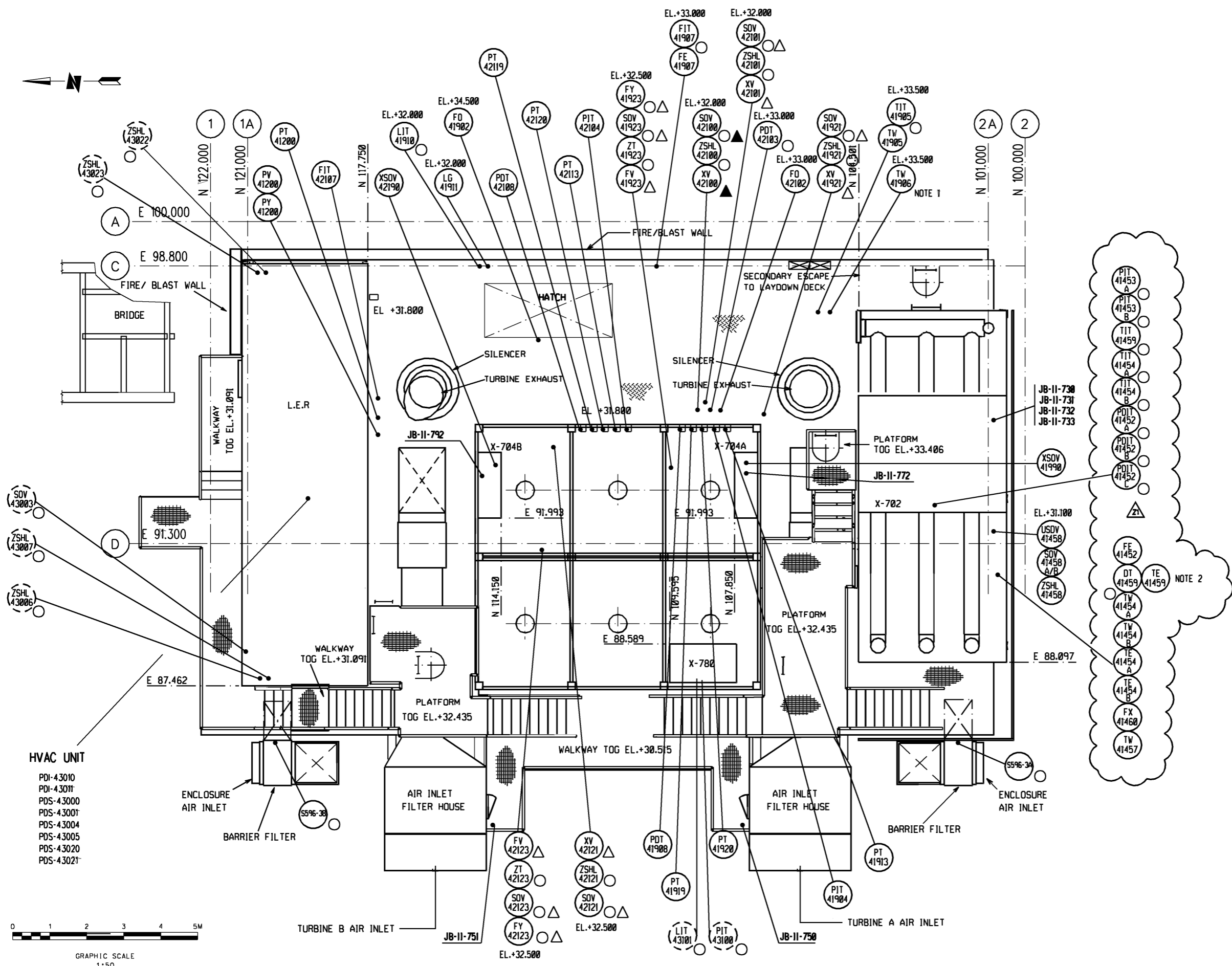

**NOTES**

1. ONLY TESTWELL

2. TE41459 IS PART OF DT41459

| DRAWING No. | DESCRIPTION | REV | DATE     | BY  | DESCRIPTION            | CHKD | APPD | APPD |
|-------------|-------------|-----|----------|-----|------------------------|------|------|------|
|             |             | Z1  | 08.03.04 | SHH | ISSUED AS-BUILT C01031 | RS   | ORD  |      |
|             |             | Z   | 98.06.12 |     | AS BUILT               |      |      |      |

ORIGINAL SIZE AT 1:50