

PLATFORM NORTH

WASTE/STORAGE SCHEDULE

1. PLASTIC/STEEL DRUM - ELECTRIC/ELECTRONIC WASTE.
2. PLASTIC/STEEL DRUM - FLUORESCENT LAMPS AND ECONOMY BULBS.
3. PLASTIC/STEEL DRUM - HAZARD WASTE.
4. BAILING PRESS - PLASTIC WASTE.
5. COMPACTOR - RESIDUAL WASTE FOR ENERGY, FOOD CONTAMINATED WASTE.
6. COMPACTOR - CARDBOARD/PAPER.

NOTES

1. NORTH EAST, WEST AND SOUTH WEST EXTERNAL STAIR TOWERS BY BAYARDS - S. SEE DRAWINGS -  
 PH-LP-N-3002-001 - PLAN VIEWS NORTH EAST TOWER  
 PH-LP-N-2002-001 - PLAN VIEWS SOUTH WEST TOWER  
 PH-LP-N-1002-001 - PLAN VIEWS WEST TOWER
2. THIS DRAWING TO READ IN CONJUNCTION WITH DETAILED ROOM LAYOUTS  
 PH-LP-C-5516-001 LQ Room Layout L1 106B Store  
 PH-LP-C-5540-001 LQ Room Layout L1 106A Platform Store  
 PH-LP-C-5541-001 LQ Room Layout L1 111 Hot Desk  
 PH-LP-C-5543-001 LQ Room Layout L1 105 Comprimator  
 PH-LP-C-5544-001 LQ Room Layout L1 109 Inst. Workshop  
 PH-LP-C-5545-001 LQ Room Layout L1 112 Electrical Workshop  
 PH-LP-C-5546-001 LQ Room Layout L1 113C & 113D Mech & Weld Washop  
 PH-LP-C-5547-001 LQ Room Layout L1 124 & 125A Locker Rooms  
 PH-LP-C-5548-001 LQ Room Layout L1 116 Male Change  
 PH-LP-C-5549-001 LQ Room Layout L1 125B Female Change 126 Shower  
 PH-LP-C-5552-001 LQ Room Layout L1 113B Coffee Shop  
 PH-LP-C-5617-001 LQ Room Layout L1 108 Lobby  
 PH-LP-C-5618-001 LQ Room Layout L1 113A Tool Storage  
 PH-LP-C-5620-001 LQ Room Layout L1 113E Chemical Workshop  
 PH-LP-C-5621-001 LQ Room Layout L1 104A Corridor  
 PH-LP-C-5622-001 LQ Room Layout L1 104B Corridor  
 PH-LP-C-5623-001 LQ Room Layout L1 104B Corridor  
 PH-LP-C-5624-001 LQ Room Layout L1 129 Dirty Linen/Janitor  
 PH-LP-C-5625-001 LQ Room Layout L1 130 CER  
 PH-LP-C-5626-001 LQ Room Layout L1 131 Battery Room  
 PH-LP-C-5627-001 LQ Room Layout L1 132 Switchboard Room  
 PH-LP-C-5628-001 LQ Room Layout L1 133 Corridor  
 PH-LP-C-5629-001 LQ Room Layout L1 134 Lobby  
 PH-LP-C-5630-001 LQ Room Layout L1 135A Transformer  
 PH-LP-C-5631-001 LQ Room Layout L1 135B Mechanical Equipment Room  
 PH-LP-C-5680-001 LQ Room Layout L1 136 EL. Shaft  
 PH-LP-C-5683-001 LQ Room Layout L1 103 EL. Shaft  
 PH-LP-C-5684-001 LQ Room Layout L1 115 Corridor

MEI 1

E 100000

2650

E 97350

9825

24900

9635

E 87525

77890

5440

E 72450

MEI (B) N 120000  
 QC N 118265  
 35000  
 16530  
 1735  
 1735  
 9235  
 9235  
 MEI (A) N 100000  
 QB N 10735  
 QA N 92500

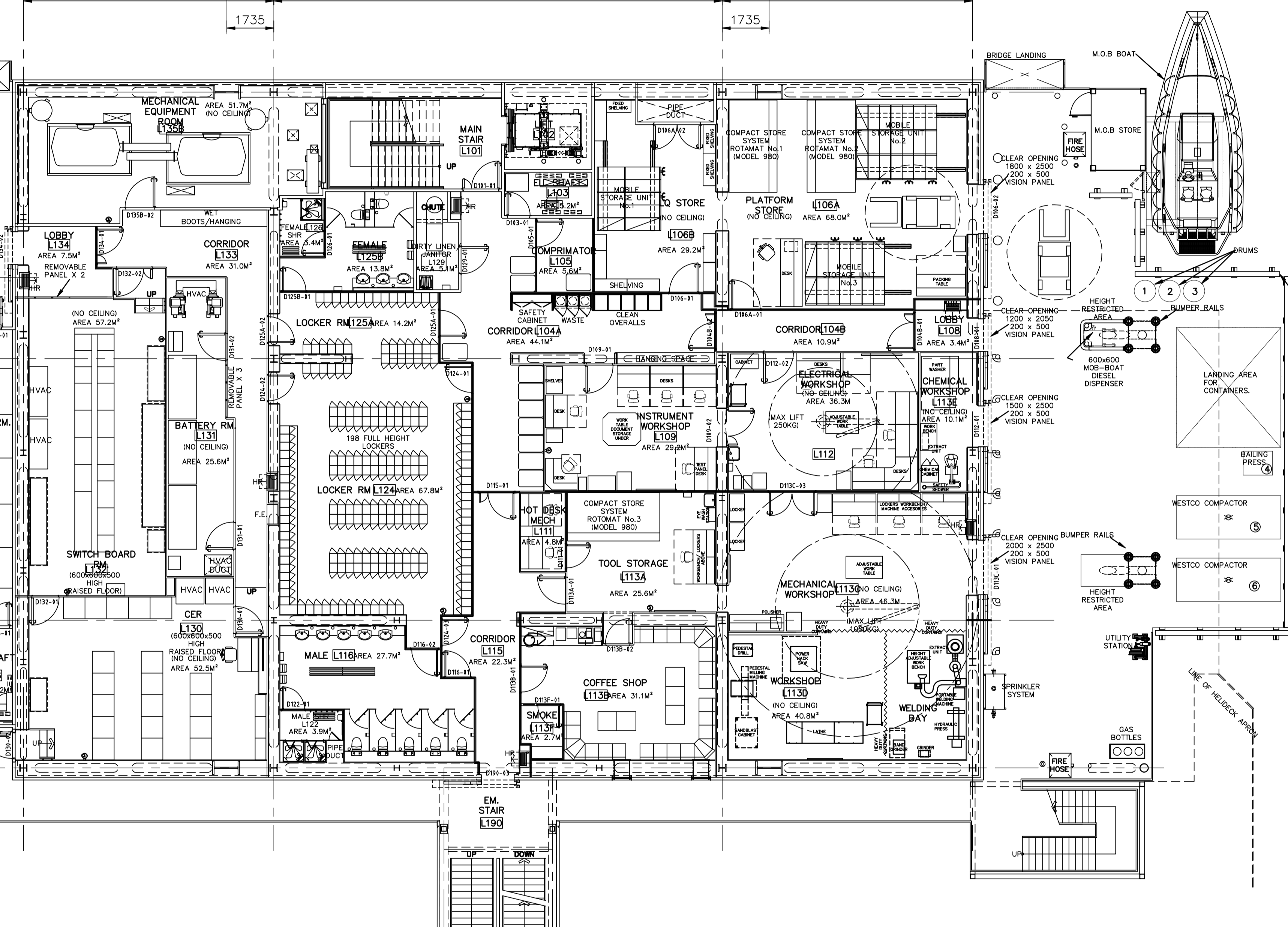

LEVEL 1  
 EL + 49.950

FOR DETAILS OF WEST STAIR ENCLOSURE SEE DWG. PH-LP-C-5531-002

| REV. No. | DESCRIPTION OF REVISION | ISSUE DATE | MADE BY | CHK'D BY | DISC. BY | PROJ. NO. | CLIENT | REV. No. | DESCRIPTION OF REVISION | ISSUE DATE | MADE BY | CHK'D BY | DISC. BY | PROJ. NO. | CLIENT | REFERENCE DRAWINGS: | DRAWING TITLE: | REGISTRATION CODES |        | DRAWING NO. |               |       |       | SCALE    |       |       |
|----------|-------------------------|------------|---------|----------|----------|-----------|--------|----------|-------------------------|------------|---------|----------|----------|-----------|--------|---------------------|----------------|--------------------|--------|-------------|---------------|-------|-------|----------|-------|-------|
|          |                         |            |         |          |          |           |        |          |                         |            |         |          |          |           |        |                     |                | AREA               | SYSTEM | TYPE        | FACILITY CODE | ORIG. | DISP. | SEQ. No. | SHEET | 1:100 |
| Z        | AS BUILT                | 02.09.10   | DA      | SW       | DH       | AD        |        |          |                         |            |         |          |          |           |        |                     |                | L1                 | 00     | XD          | PH            | LP    | C     | 5301     | 001   | Z     |

WALHALL RE-DEVELOPMENT  
 PROJECT No. C06106



SLP ENGINEERING LTD  
 HAMILTON ROAD  
 LOWESTOFT  
 SUFFOLK, NR32 1XF

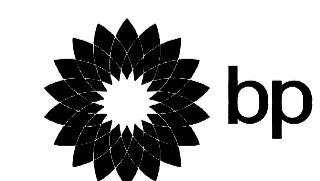

LIVING QUARTERS  
 GA LAYOUT  
 LEVEL 1